



POWRÓT DO STRONY GŁÓWNEJ 

# Koło łańcuchowe z piastą 3/8" x 7/32" (06B -1 - 2 -3) pod Taper Lock® dla łańcucha rolkowego DIN 8187/ ISO R606

Material

patrz niżej

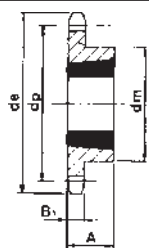
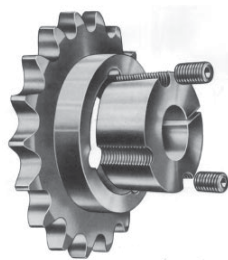

Typ 1

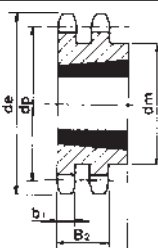

Typ 2

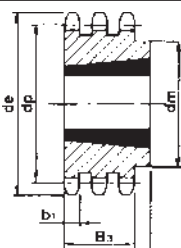

Typ 4

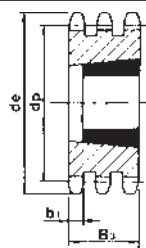

Typ 5

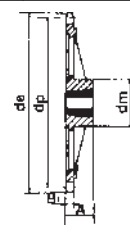

Typ 6

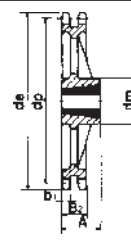

Typ 7

## 1-rzędowe

Kod	Ilość zębów z	de	dp	Tuleja Taper Lock®	Typ	dm	A
T 43966	17	55.5	51.83	1008	1	45	22
T 64986	18	58.6	54.85	1008	1	45	22
T 43967	19	61.6	57.86	1008	1	45	22
T 64987	20	64.6	60.89	1008	1	46	22
T 43968	21	67.6	63.90	1008	1	46	22
T 64988	22	70.6	66.93	1108	1	55	22
T 43969	23	73.7	69.95	1210	1	63	25
T 64989	24	76.7	72.97	1210	1	63	25
T 43970	25	79.7	75.99	1210	1	63	25
T 43971	27	85.7	82.04	1210	1	63	25
T 43972	30	94.8	91.12	1210	1	63	25
T 43973	38	119.0	115.34	1210	1	70	25
T 43975	57	177.5	172.91	1210	6	83	25
T 43976	76	235.1	230.49	1210	6	83	25

## 2-rzędowe

T 44040	17	55.5	51.83	1008	2	41	22
T 44041	19	61.6	57.86	1008	2	46	22
T 44042	21	67.6	63.90	1008	2	49	22
T 44043	23	73.7	69.95	1210	2	59	25
T 44044	25	79.7	75.99	1210	2	64	25
T 44045	27	85.7	82.04	1210	2	70	25
T 44046	30	94.8	91.12	1210	2	75	25
T 44047	38	119.0	115.34	1610	2	80	25
T 44049	57	177.5	172.91	1610	7	92	25
T 44050	76	235.1	230.49	1610	7	92	25

## 3-rzędowe

T 65011	17	55.5	51.83	1008	5	-	25.6
T 65012	19	61.6	57.86	1008	5	-	25.6
T 65013	21	67.6	63.90	1008	5	-	25.6
T 65014	23	73.7	69.95	1210	5	-	25.6
T 65015	25	79.7	75.99	1210	5	-	25.6
T 65016	27	85.7	82.04	1210	5	-	25.6
T 65017	30	94.8	91.12	1615	4	79	38.0
T 65018	38	119.0	115.34	1615	4	90	38.0

B1	B2	B3	r3	c	b1
5.3	15.4	25.6	10	1	5.2

### Material:

Typ 1, 2, 4, 5:

Stal C 43

Typ 6, 7:

Żeliwo

Rozmiary w mm.

### Uwaga:

Tuleja pod Taper Lock® patrz strona K 25 - K 29.

# Koło łańcuchowe z piastą 1/2"x5/16" (08B -1 -2 -3) pod Taper Lock® dla łańcucha rolkowego DIN 8187/ ISO R606

Materiał  
patrz niżej

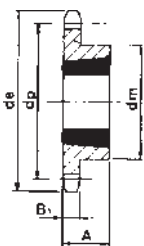
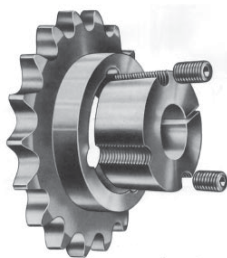

Typ 1

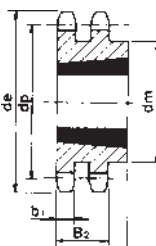

Typ 2

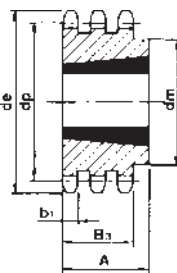

Typ 4

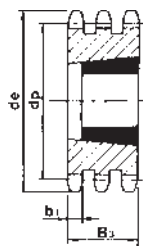

Typ 5

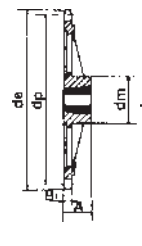

Typ 6

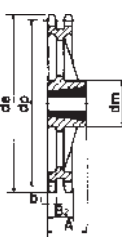

Typ 7

## 1-rzędowe

Kod	Ilość zębów z	de	dp	Tuleja Taper Lock®	Typ	dm	A
T 43979	15	66.5	61.80	1008	1	45	22
T 64990	16	69.9	65.10	1108	1	50	22
T 43980	17	74.5	69.11	1210	1	60	25
T 64991	18	78.0	73.14	1210	1	60	25
T 43981	19	82.5	77.15	1210	1	63	25
T 64992	20	86.0	81.19	1610	1	67	25
T 43982	21	90.6	85.21	1610	1	71	25
T 64993	22	94.1	89.24	1610	1	71	25
T 43983	23	98.7	93.26	1610	1	76	25
T 64994	24	102.1	97.29	1610	1	76	25
T 43984	25	106.7	101.32	1610	1	76	25
T 43985	27	114.8	109.39	1610	1	76	25
T 43986	30	126.9	121.49	2012	1	90	32
T 43987	38	159.2	153.79	2012	1	90	32
T 43989	57	237.1	230.54	2012	6	111	32
T 43990	76	313.9	307.33	2012	6	111	32

## 2-rzędowe

T 44053	15	66.5	61.80	1008	2	46	22
T 44054	17	74.5	69.11	1210	2	56	25
T 44055	19	82.5	77.15	1210	2	62	25
T 44056	21	90.6	85.21	1610	2	70	25
T 44057	23	98.7	93.26	1610	2	79	25
T 44058	25	106.7	101.32	2012	2	87	32
T 44059	27	114.8	109.39	2012	2	87	32
T 44060	30	126.9	121.49	2012	2	87	32
T 44061	38	159.2	153.79	2012	2	100	32
T 44063	57	237.1	230.54	2012	7	111	32
T 44064	76	313.9	307.33	2012	7	111	32

## 3-rzędowe

T 65019	15	66.5	61.80	1008	5	-	34.9
T 65020	17	74.5	69.11	1210	5	-	34.9
T 65021	19	82.5	77.15	1215	4	62	38.0
T 65022	21	90.6	85.21	1615	4	70	38.0
T 65024	23	98.7	93.26	1615	4	70	38.0
T 65025	25	106.7	101.32	2012	5	-	34.9
T 65026	27	114.8	109.39	2012	5	-	34.9
T 65027	30	126.9	121.49	2012	5	-	34.9
T 65028	38	159.2	153.79	2012	5	-	34.9

B1	B2	B3	r3	c	b1
7.2	21	34.9	13	1.3	7

### Materiał:

Typ 1, 2, 4, 5:

Stal C 43

Typ 6, 7:

Żeliwo

### UWAGA:

Tuleja pod Taper Lock® patrz strona K 25 - K 29.

Rozmiary w mm.

# Koło łańcuchowe z piastą 5/8" x 3/8" (10B -1 -2 -3) pod Taper Lock® dla łańcucha rolkowego DIN 8187/ ISO R606

Materiał

patrz niżej

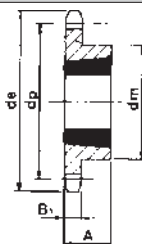
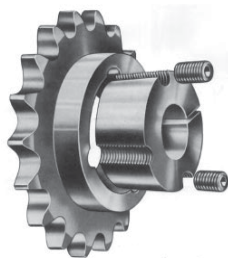

Typ 1

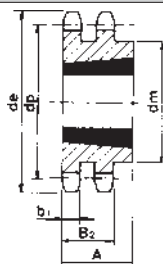

Typ 2

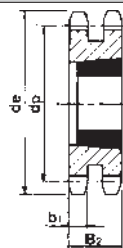

Typ 3

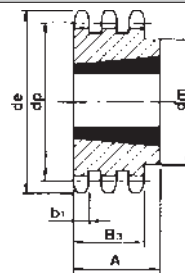

Typ 4

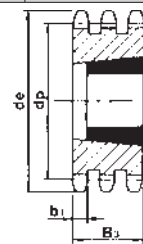

Typ 5

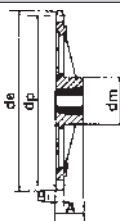

Typ 6

## 1-rzędowe

Kod	Ilość zębów z	de	dp	Tuleja Taper Lock®	Typ	dm	A
T 43993	13	73.2	66.33	1008	1	47	22
T 43994	15	83.2	76.35	1210	1	60	25
T 64995	16	88.3	81.37	1210	1	63	25
T 43995	17	93.3	86.39	1610	1	71	25
T 64996	18	98.3	91.42	1610	1	71	25
T 43996	19	103.3	96.44	1610	1	75	25
T 64997	20	108.4	101.49	1610	1	76	25
T 43997	21	113.4	106.51	1610	1	76	25
T 64998	22	118.4	111.55	1610	1	76	25
T 43998	23	123.5	116.58	1610	1	76	25
T 64999	24	128.5	121.62	2012	1	90	32
T 43999	25	133.6	126.66	2012	1	90	32
T 44000	27	143.6	136.74	2012	1	90	32
T 44001	30	158.8	151.87	2012	1	90	32
T 44002	38	199.1	192.23	2012	1	100	32
T 44004	57	296.6	288.18	2012	6	111	32
T 44005	76	392.5	384.16	2012	6	111	32

## 2-rzędowe

T 44067	15	83.2	76.35	1210	3	-	25.5
T 44068	17	93.3	86.39	1610	3	-	25.5
T 44069	19	103.3	96.44	1610	3	-	25.5
T 44070	21	113.4	106.51	1610	3	-	25.5
T 44071	23	123.5	116.58	1610	3	-	25.5
T 44072	25	133.6	126.66	2012	2	90	32.0
T 44073	27	143.6	136.74	2012	2	90	32.0
T 44074	30	158.8	151.87	2012	2	90	32.0

## 3-rzędowe

T 65029	15	83.2	76.35	1215	5	-	42.1
T 65030	17	93.3	86.39	1215	5	-	42.1
T 65031	19	103.3	96.44	1615	5	-	42.1
T 65032	21	113.4	106.51	1615	5	-	42.1
T 65033	23	123.5	116.58	2012	5	-	42.1
T 65034	25	133.6	126.66	2517	4	105	44.0
T 65035	27	143.6	136.74	2517	4	110	44.0
T 65036	30	158.8	151.87	2517	4	120	44.0

B1	B2	B3	r3	c	b1
9.1	25.5	42.1	16	1.6	9

### Materiał:

Typ 1 - 5:

Stal C 43

Typ 6:

Żeliwo

Rozmiary w mm.

### UWAGA:

Tuleja pod Taper Lock® patrz strona K 25 - K 29.

# Koło łańcuchowe z piastą 3/4"x7/16" (12B -1 -2 -3) pod Taper Lock® dla łańcucha rolkowego DIN 8187/ ISO R606

Material

patrz niżej

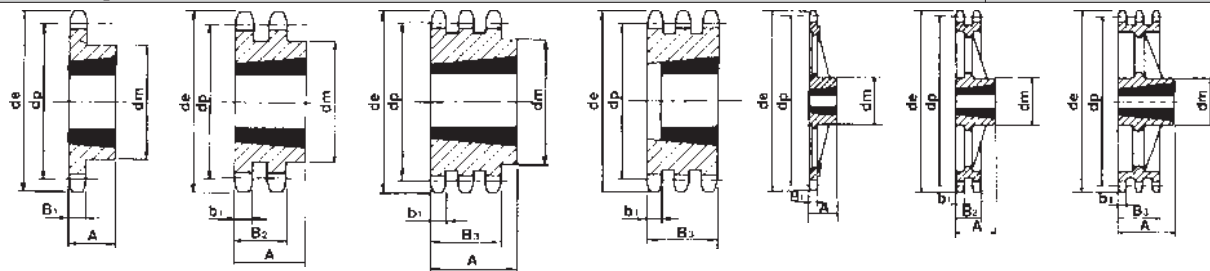

Typ 1

Typ 2

Typ 4

Typ 5

Typ 6

Typ 7

Typ 8

## 1-rzędowe

Kod	Ilość zębów z	de	dp	Tuleja Taper Lock®	Typ	dm	A
T 44008	13	87.8	79.60	1210	1	60	25
T 44009	15	99.8	91.62	1610	1	70	25
T 65000	16	105.8	97.65	1610	1	71	25
T 44010	17	111.9	103.67	1610	1	76	25
T 65001	18	117.9	109.71	2012	1	90	32
T 44011	19	123.9	115.73	2012	1	90	32
T 65002	20	130.0	121.78	2012	1	90	32
T 44012	21	136.0	127.81	2517	1	102	44
T 65003	22	142.0	133.86	2517	1	108	44
T 44013	23	148.1	139.90	2517	1	108	44
T 65004	24	154.1	145.94	2517	1	108	44
T 44014	25	160.2	151.99	2517	1	108	44
T 44015	27	172.3	164.09	2517	1	108	44
T 44016	30	190.4	182.24	2517	1	108	44
T 44017	38	238.9	230.69	2517	1	108	44
T 44019	57	355.9	345.81	2517	6	124	44
T 44020	76	471.1	460.99	2517	6	124	44

## 2-rzędowe

T 44076	15	99.8	91.62	1615	2	71	38
T 44077	17	111.9	103.67	1615	2	80	38
T 44078	19	123.9	115.73	2012	2	90	32
T 44079	21	136.0	127.81	2517	2	108	44
T 44080	23	148.1	139.90	2517	2	108	44
T 44081	25	160.2	151.99	2517	2	108	44
T 44082	27	172.3	164.09	2517	2	108	44
T 44083	30	190.4	182.24	2517	2	108	44
T 44084	38	238.9	230.69	3020	2	140	51
T 44086	57	355.9	345.81	3020	7	160	51
T 44087	76	471.1	460.99	3020	7	160	51

## 3-rzędowe

T 44104	15	99.8	91.62	1615	5	-	49.8
T 44105	17	111.9	103.67	1615	5	-	49.8
T 44106	19	123.9	115.73	2012	5	-	49.8
T 44107	21	136.0	127.81	2517	5	-	49.8
T 44108	23	148.1	139.90	2517	5	-	49.8
T 44109	25	160.2	151.99	2517	5	-	49.8
T 44110	27	172.3	164.09	3020	4	140	51.0
T 44111	30	190.4	182.24	3020	4	140	51.0
T 44112	38	238.9	230.69	3020	4	140	51.0
T 44114	57	355.9	345.81	3020	8	160	51.0

B1	B2	B3	r3	c	b1
11.1	30.3	49.8	19	2	10.8

### Material:

Typ 1, 2, 4, 5: Stal C 43; 6 - 8: żeliwo

### UWAGA:

Tuleja pod Taper Lock® patrz. strona K 25 - K 29.

Rozmiary w mm.

# Koło łańcuchowe z piastą 1" x 17.02 mm (16B -1 -2 -3) pod Taper Lock® dla łańcucha rolkowego DIN 8187/ ISO R606

Material

patrz niżej

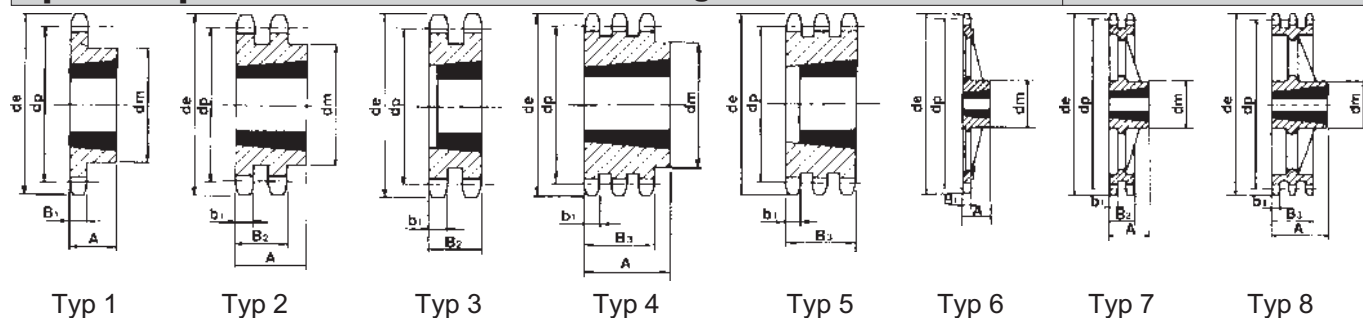

## 1-rzędowe

Kod	Ilość zębów z	de	dp	Tuleja Taper Lock®	Typ	dm	A
T 44023	13	117.7	106.13	1615	1	73	38
T 44024	15	133.7	122.16	1615	1	76	38
T 65005	16	141.8	130.20	2012	1	90	32
T 44025	17	149.8	138.23	2012	1	90	32
T 65006	18	157.8	146.28	2517	1	108	44
T 44026	19	165.9	154.31	2517	1	108	44
T 65007	20	173.9	162.38	2517	1	110	44
T 44028	21	182.0	170.42	2517	1	110	44
T 65008	22	190.1	178.48	2517	1	110	44
T 44029	23	198.1	186.53	2517	1	110	44
T 65009	24	206.2	194.59	2517	1	110	44
T 44031	25	214.2	202.66	2517	1	110	44
T 44032	27	230.4	218.79	2517	1	110	44
T 44033	30	254.6	242.99	2517	1	120	44
T 44034	38	319.2	307.59	3020	6	160	51
T 44036	57	474.9	461.07	3020	6	160	51
T 44037	76	628.4	614.65	3020	6	160	51

## 2-rzędowe

T 44090	15	133.7	122.16	2012	3	-	47.7
T 44091	17	149.8	138.23	2517	3	-	47.7
T 44092	19	165.9	154.31	2517	3	-	47.7
T 44093	21	182.0	170.42	3020	2	140	51.0
T 44094	23	198.1	186.53	3020	2	140	51.0
T 44095	25	214.2	202.66	3020	2	140	51.0
T 44096	27	230.4	218.79	3020	2	140	51.0
T 44097	30	254.6	242.99	3030	2	140	76.0
T 44098	38	319.2	307.59	3030	7	160	76.0
T 44100	57	474.9	461.65	3535	7	178	89.0

## 3-rzędowe

T 44118	17	149.8	138.23	2517	5	-	79.6
T 44119	19	165.9	154.31	3030	5	-	79.6
T 44120	21	182.0	170.42	3030	5	-	79.6
T 44121	23	198.1	186.53	3535	4	159	89.0
T 44122	25	214.2	202.66	3535	4	175	89.0
T 44123	27	230.4	218.79	3535	4	175	89.0
T 44124	30	254.6	242.99	3535	4	175	89.0
T 44125	38	319.2	307.59	3535	8	178	89.0
T 44127	57	474.9	461.07	4040	8	216	102.0

B1	B2	B3	r3	c	b1
16.2	47.7	79.6	26	2.5	15.8

### Material:

Typ 1 - 5: Stal C 43; 6 - 8: żeliwo

### Uwaga:

Tuleja pod Taper Lock® patrz strona K 25 - K 29.

Rozmiary w mm.